

User manual

Smartwatch

For Smartphones with Bluetooth



Product number: WD67269

PACKAGE CONTENT

Congratulations on the purchase of your new device. Before using the device, please make sure that the following items are included in the package:

Quantity	Accessories	Note
1	Smartwatch	-
2	Additional bracelet	Black & Grey
1	Wireless Charging	-
1	User manual	-

TECHNICAL SPECIFICATIONS

Size of dial:	44,5 x 38 x 11,5 mm
Bracelet length:	270mm
Screen:	1.92 inches TFT
Weight:	40 g
Standby time:	Up to 6 days of continuous operation (standby: 20 days).
System requirements:	iOS 10.0 or above, Android 6.0 or above, Bluetooth 5.1
Waterproof:	IP67
Battery:	Integrated Rechargeable Lithium Battery
Ambient temperature:	0-40°C
Frequency band	UHF-Frequenzband
Max. Transmitting power	1,56 mW

SCHEMATIC VIEW OF THE MAIN BODY OF THE SMARTWATCH

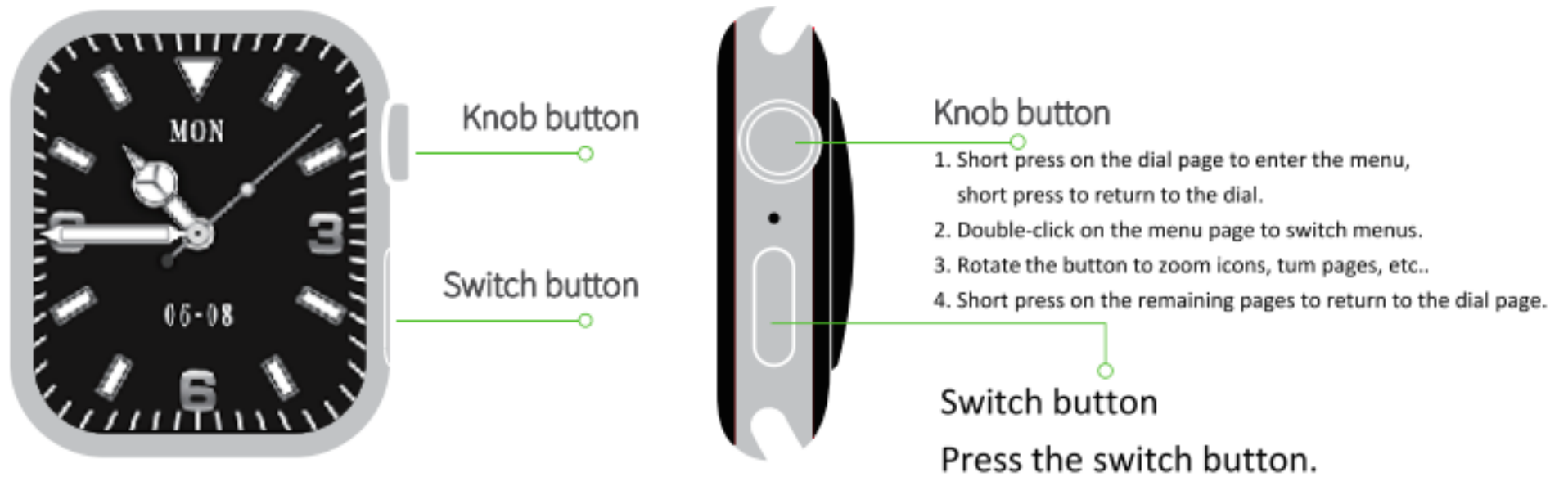

Switch on

To charge the Smartwatch, put the back side of Smartwatch connect the appropriate wireless charging.



To charge, place the back of your watch on the wireless charger



DOWNLOAD OF THE APP AND CONNECTION OF THE SMARTWATCH

1. Download and installation of the APP

1.1 Scan the QR code to download the APP with the mobile phone.



For Android



For iOS

1.2 Select RD Fit for the IOS system in the App Store search.

For the Android system, select and install the RD Fit app in the Playstore for download or scan the QR Code for download

Note: Your mobile phone must support Android 6.0 or IOS 10.0 or higher and Bluetooth 4.0 or higher.

2. Connection of the Smartwatch to the app

2.1 Click "Add Device" to pair the Smartwatch. (P.2)

2.2 Click your Device WD67269 in scanned list. The device confirm and pair it with Android system directly. (P.3)

2.3 The IOS system displays a Bluetooth pairing request and you can click Bluetooth "Pairing" to confirm (P.3 to P.4)

2.4 When "WD67269" Successfully connected, the system will automatically pop up a prompt. (P.6) (Tips: If there isn't prompt, please go to TIPS)

2.5 Press the long button on the side of watch, swipe down on the main page, pull down the page, and check that the icon is enabled on the page. (P.7)

2.6 Click "WD67269 Call" on the mobile phone to connect to the call. (P.8)

2.7 Successfully connected. (P.9)

TIPS:

* If it is in operation, there is no pop-up the prompt.

Please connect according to Step 2.6 to 2.7.

* If the watch has been connected to another mobile phone, please enter that phone's Bluetooth settings of the mobile phone, clear the Bluetooth record of the watch and then reconnect to the new mobile phone to avoid confusion in the Bluetooth connection.



1

Open the package. Follow the steps to connect the strap to the smart watch



2

Wear the smart watch and press and hold the button to turn on.

3

Open RD fit APP on your phone to set up the device
To charge, place the back of your watch with the charger cable



P1

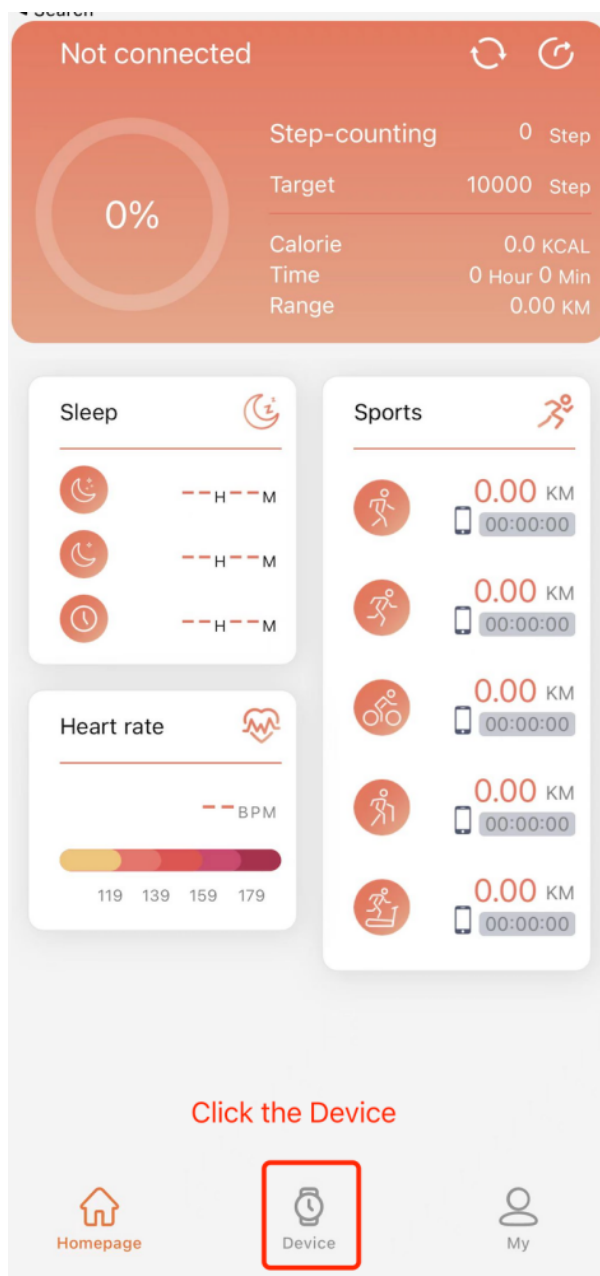

P2

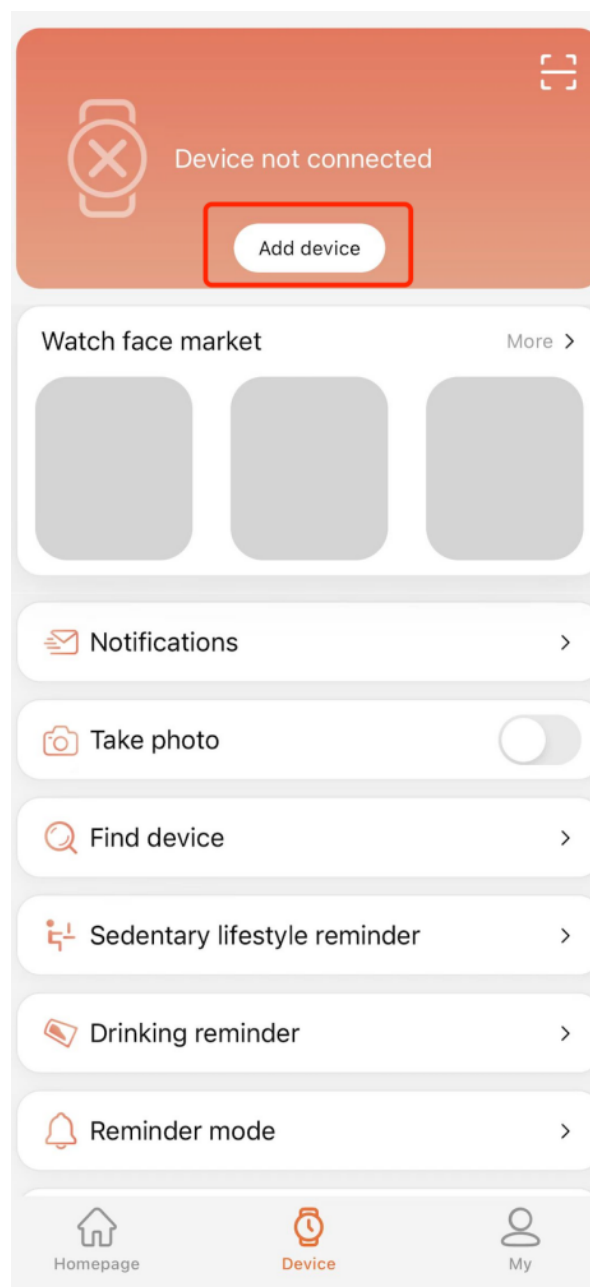

P3

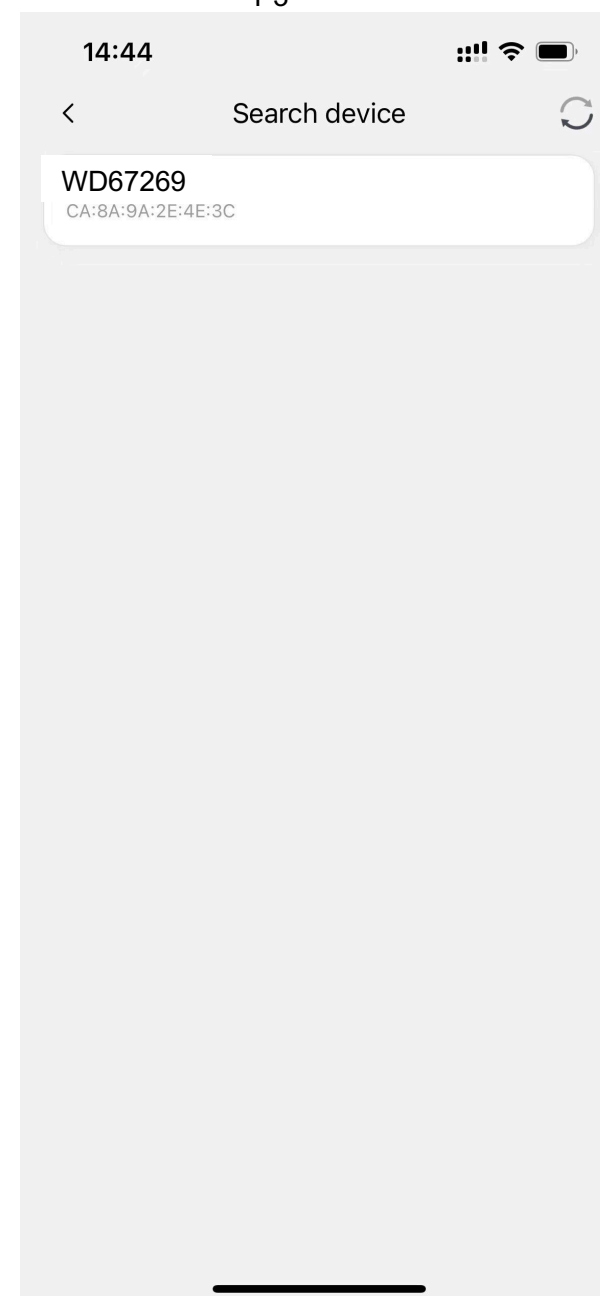

P4

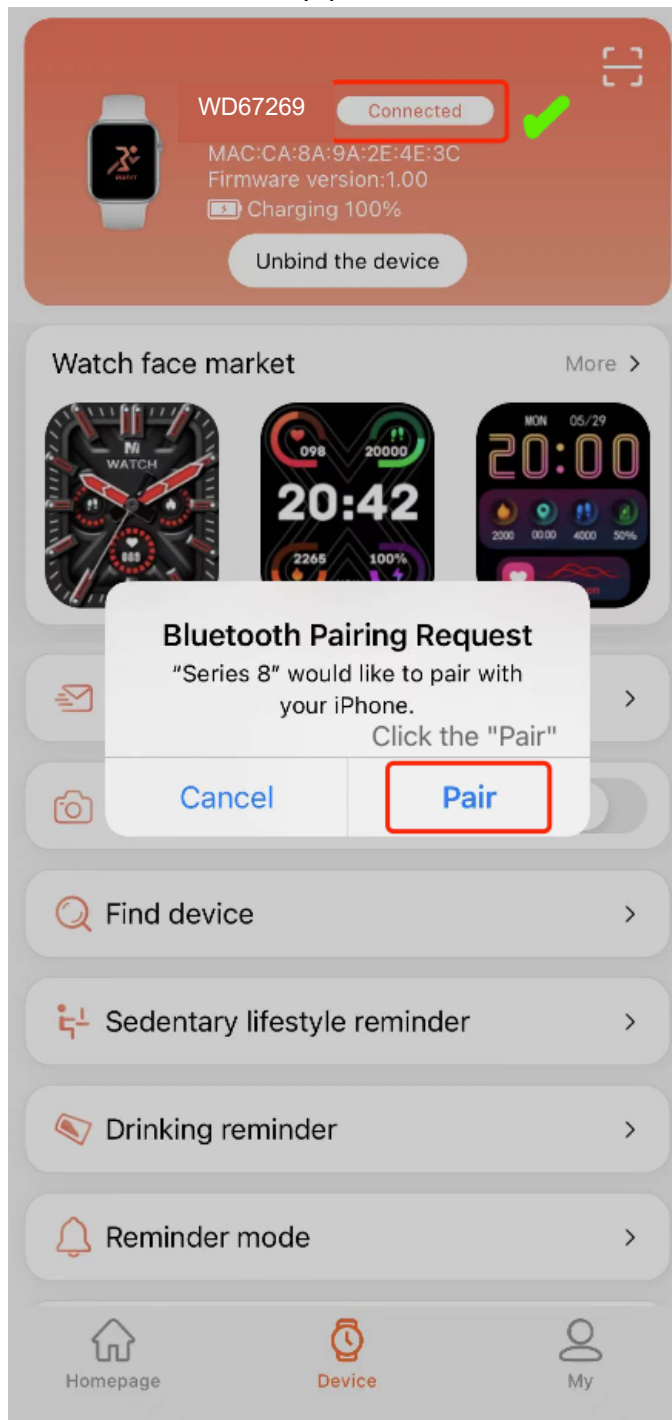

P5

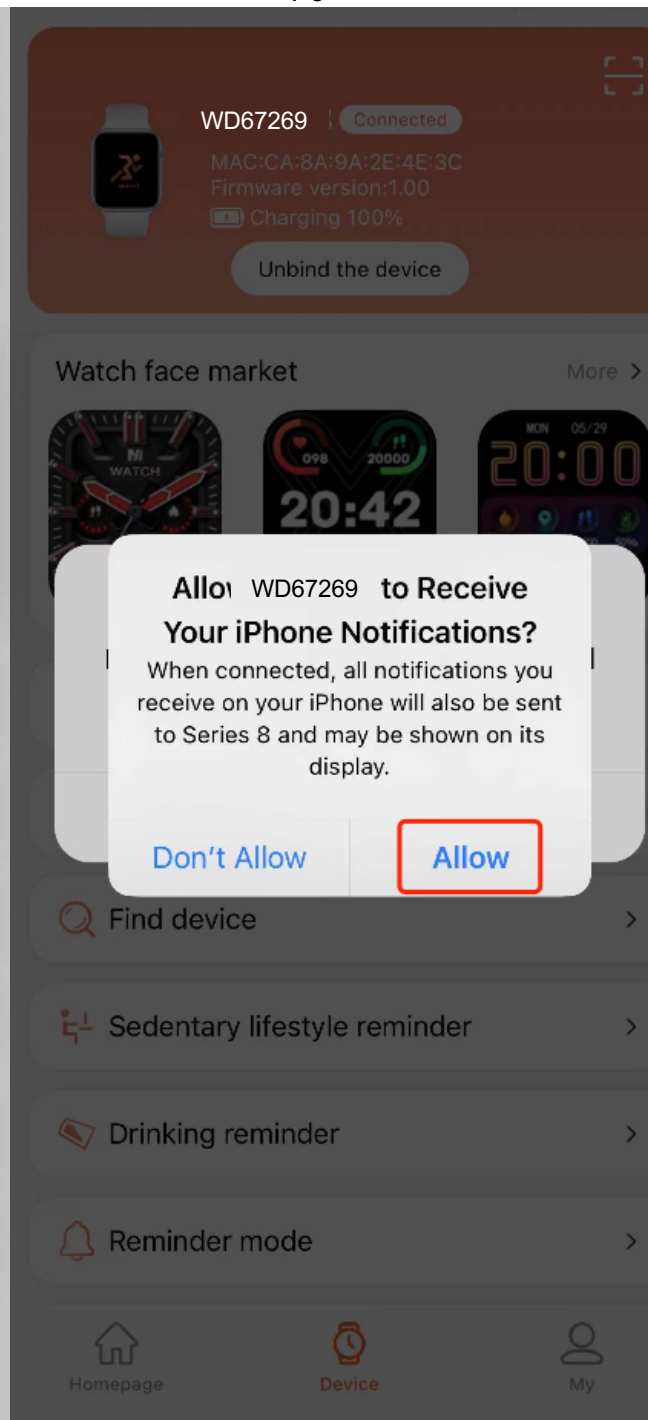

P6

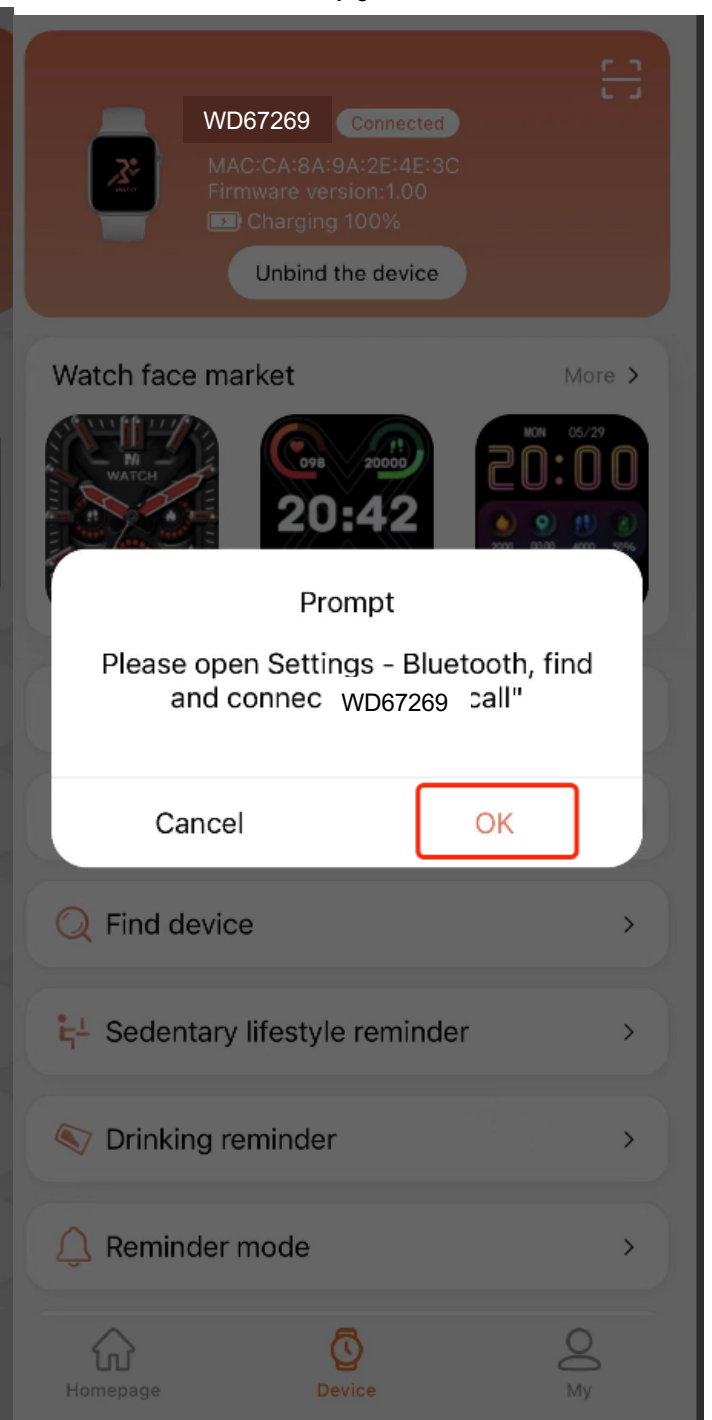

P7



P8

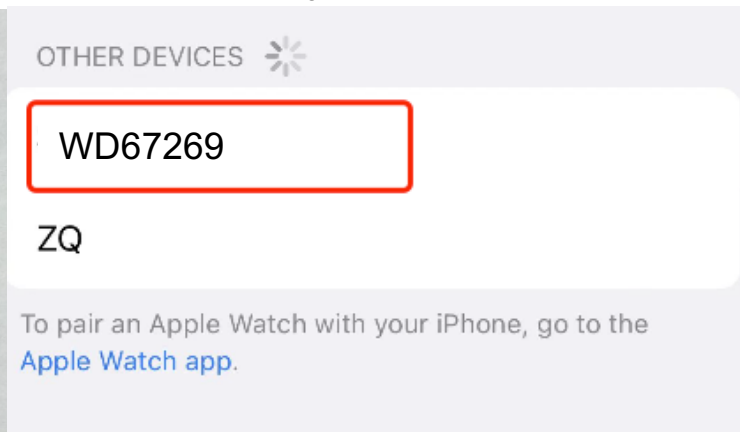

P9

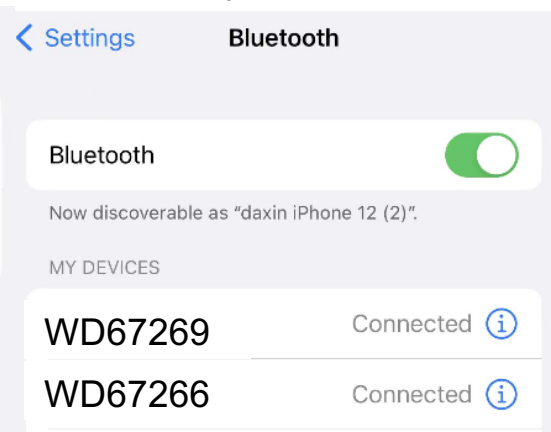

INTRODUCTION TO THE FUNCTIONS OF THE SMARTWATCH

In the power-on state, you can switch the menu interfaces of the main screen and display the user interfaces shown below:

STEPS

The step-counting interface shows steps. Wear the smart bracelet on wrist, and the smart bracelet can automatically count steps, distance and calories.

MESSAGE

You can view the content pushed by the message in the information interface. At most three messages can be saved. After three messages are saved, the messages displayed before will be replaced by new messages one by one. In the information interface, press and hold for 2 seconds to delete the content.

SLEEP

Wearing the smart bracelet at night to automatically judge whether you are in the sleep state, to record deep sleep and light sleep respectively, and to summarize the total sleep time to help you monitor your sleep quality. The sensor can measure your sleep quality according to the range and frequency of wrist movements when you sleep.

Note: Because users' sleep time and habits are different, the time of sleep monitoring is only for reference.

Heart Rate Measurement

Enter the heart rate test interface, the motor will vibrate once after “Start measurement” and “Stop”, and the current measurement data will be displayed.

TRAINING

There are many kinds of sports in the sports interface, including walking, running, cycling, rope skipping, badminton, basketball and football etc..

WEATHER

The weather page displays the current weather and tomorrow's weather, and slide right to show the weather forecast for the next 4 days.

For weather information, it needs to connect with the client end before data can be obtained. If the disconnection time is long, the weather information cannot be updated.

MUSIC

After connecting with the mobile phone, the smart bracelet can control the music player of the mobile phone. When the mobile phone plays music, you can use the smart bracelet to control the mobile phone for playing/pausing, the previous song and the next song.

BRIGHTNESS

Click the icon to select screen brightness, slide to the right to exit and save the record.

CAMERA

After connecting with the mobile phone, the smart bracelet can be used as a remote controller for the mobile phone camera. Open "Photo control" in APP and click on the icon to take a photo.

TIMER

Open this function to perform single and multiple timing times

FLASHLIGHT

After opening, the screen will be adjusted to the maximum brightness and always on, and you can exit the interface after swiping left.

MORE

Click the "More" icon to enter the function interface. Rotate Slide Button to change the dial plates.

POWER OFF

Slide "POWER OFF" to turn off the smart bracelet.

RESET

Click on "Confirm" to clear all data in the smart bracelet, and to restore factory settings.

REMOVE DEVICE

With an Android mobile phone, the device can be disconnected from your mobile phone by simply clicking on 'Remove Device'.

For Apple mobile phones, after disconnecting, click on the icon to the right under Settings - Bluetooth and select the device to ignore as shown below.

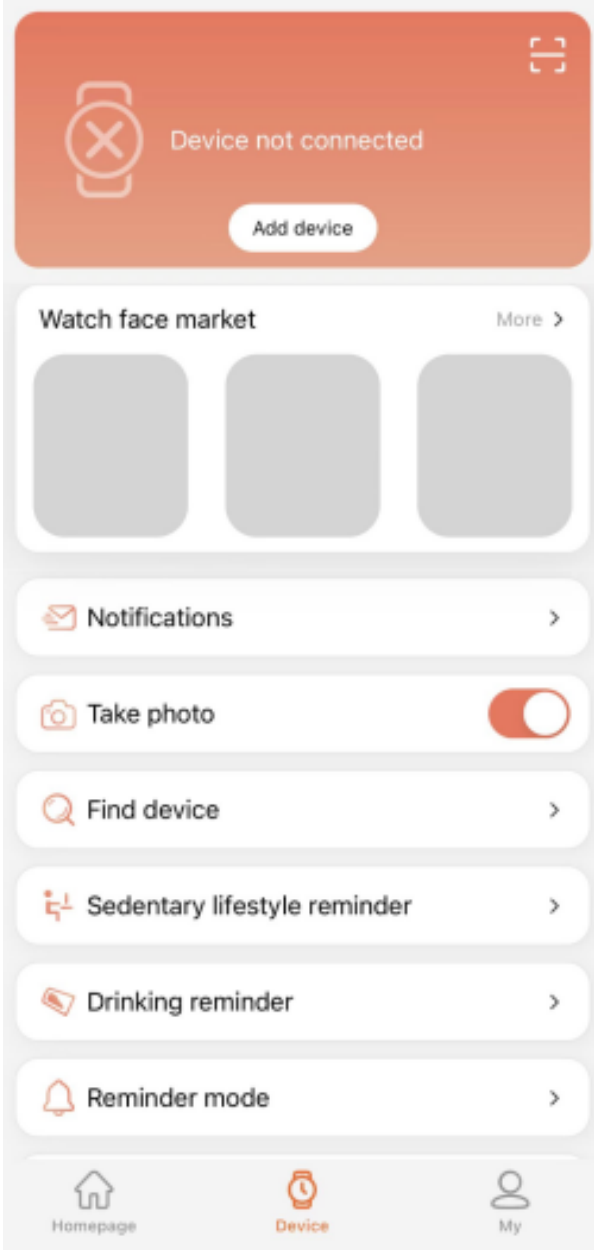
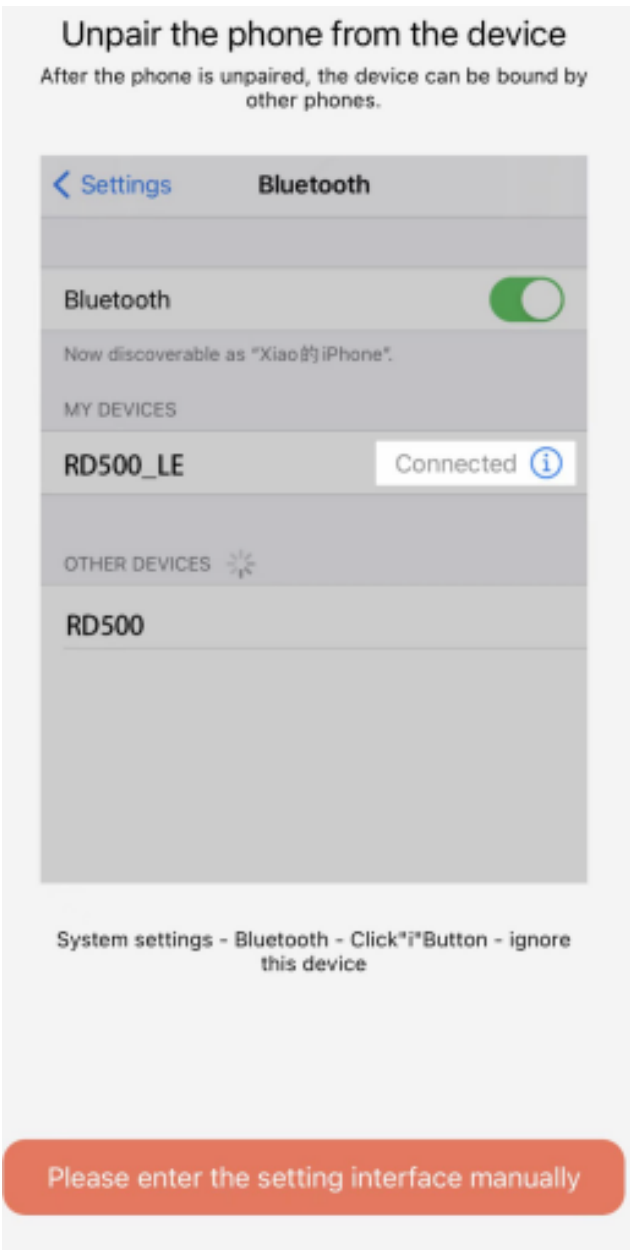
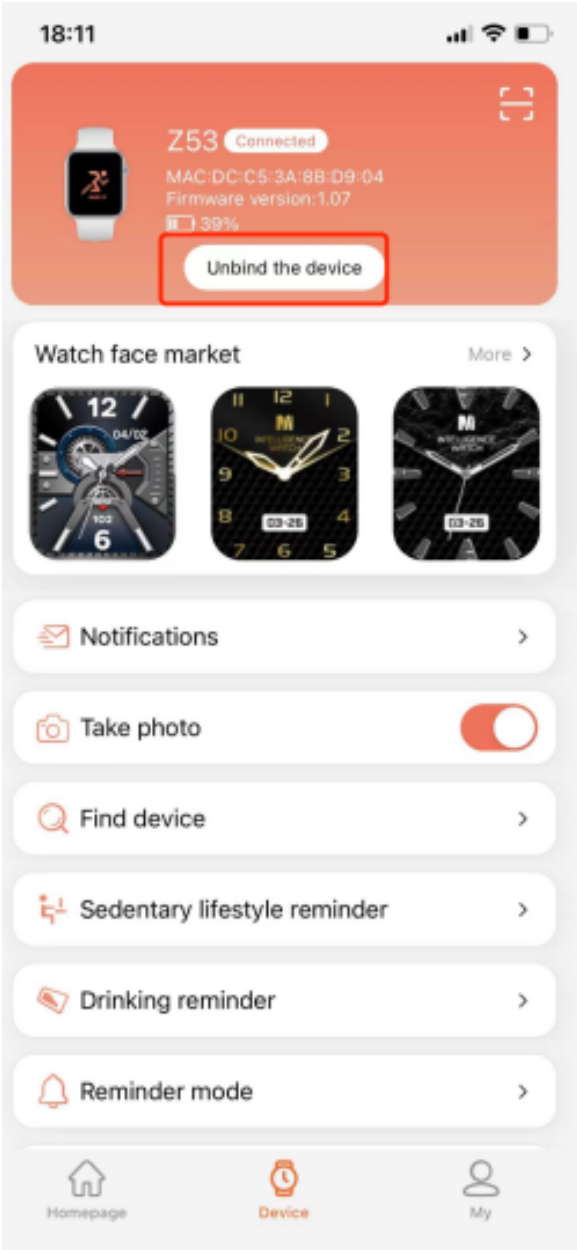

FREQUENTLY ASKED QUESTIONS (FAQs)

1. Why does the Smartwatch automatically disconnect the Bluetooth connection when the Android screen goes off?

Answer:

- 1 > Background process of the RD Fit app is blocked. If the RD Fit process is interrupted, the Smartwatch will disconnect from the mobile phone.
- 2 > Set APP self-start. Set the app to start automatically in the phone settings.
- 3 > Enable unrestricted background operation for the RD Fit app. The Android mobile phone that has the APP installed intelligently limits the background operation by default and the app should be set manually without any restrictions.

2. Why can't the Smartwatch receive push messages?

Answer:

- 1> Please check that you have enabled the authorization for push messages in the phone settings.
- 2> Please check that messages can be displayed normally in the notification bar of the mobile phone. The push message can only be received by the Smartwatch if the display in the notification bar of the phone is enabled. The Smartwatch will not receive the Push message if there is no message in the notification bar of the mobile phone. (You must find the notification settings in the mobile phone settings and turn on the notification switch of Call, SMS, and WhatsApp).
- 3 > Display the settings of the mobile phone. In the top search box, type "Notifications" and open RD Fit again.

3. Why can't you take a hot bath with the Smartwatch?

Answer: The bath water has a relatively high temperature and produces a lot of steam, which is in the gas phase with a small molecular radius and can easily penetrate the Smartwatch through the shell gap. When the temperature drops, the steam condenses to droplets in the liquid phase, which can easily cause a short circuit inside the Smartwatch and damage the circuit board and then the Smart Bracelet.

4. Why can't you take to swim with the Smartwatch?

Answer: While the water resistance of this watch protects the device from short-term immersion, swimming involves prolonged immersion in water while also potentially exposing yourself to high water pressure. Therefore, there is no guarantee that the water resistance will be fully maintained during swimming. Therefore, if you need to use your equipment while swimming, it is best to choose waterproof equipment that is specifically designed for swimming.

NOTES

Please note the following these advices for caring for your Smartwatch:

- Clean your Smartwatch regularly, especially on the inside, and keep it dry.
- Adjust the width of the Smartwatch to ensure air circulation.
- Avoid excessive use of skin care products on the wrist on the wrist wearing the Smartwatch.
- Prolonged use may in very rare cases cause skin irritation or discomfort. If redness, swelling, itching or other allergic symptoms appear on the skin, stop using the band or wear it only over clothing. If the symptoms do not go away, please see your doctor.
- The electronic components contained in this product may cause injury if the watch is not used properly.
- Do not use the tracker while driving to watch news or similar.
- This product is not a toy. It must not be placed within the reach of children and pets. This product contains small parts that could be swallowed and could cause choking.

CARE INSTRUCTIONS

- Please use a dry, soft cloth to remove dust, abrasion etc.
- More severe soiling can be removed with a damp cloth.
- Never use fuels, solvents and aggressive or abrasive cleaning agents to clean the machine to prevent damage and malfunction.
- In order to maintain the service life of the integrated, non-replaceable battery, it is recommended that a full charge be made every 3 months, at least once every six months if the device is not to be used or stored for a long period of time.
- Avoid contact with sharp-edged objects to prevent scratches.

SAFETY INSTRUCTIONS

- The device must not be exposed to any mechanical stress such as shocks, impacts, dropping, high and very low temperatures, radiation in the optical as well as in the radio range, bending or pressure loads.
- During the charging process the device must not be exposed to liquids, high humidity or rain.
- The device must not be stored near sources of heat, high levels of sunlight, cooking areas or open fire.
- The unit has no parts that require maintenance. It must not be opened or disassembled.
- If the display is broken, do not use it again.
- Do not place the appliance in a washing machine or tumble dryer.
- Not suitable for a sauna or steam bath.

BATTERY NOTE

- The battery is permanently integrated into the device and cannot be

replaced.

- Only use chargers whose characteristics comply with the specifications in the operating instructions. The use of unsuitable chargers and/or power supply units can cause serious damage!
- The battery must never be brought into contact with fire
- Do not wear the device during charging.

HEALTH ADVICE

WARNING: THIS SMARTWATCH IS NOT A MEDICAL DEVICE!

The Smartwatch and any accessories or software used in connection therewith must not be used to diagnose, treat or prevent any disease or medical condition. Always consult a qualified medical professional before making any changes to your exercise, sleep patterns or diet. Failure to do so may result in serious damage to your health or death!

Please consult your doctor before you start a new sport.

The Smartwatch should not be used for medical purposes, although it can monitor your heartbeat dynamically and in real time.

DISPOSAL

This device contains materials that must not be disposed of as household waste. Please check local laws concerning the applicable disposal regulations. Protect the environment by participating in recycling programs!



Declaration of Conformity

LEICKE GmbH herewith declares that the devices WD67269 comply with the RED 2014/53/EU and ROHS 2011/65/EC Annex II 2015/863 as last amended by Directive(EU) 2017/2102 regulations



The declaration of conformity can be found at: www.leicke.de and search WD67269

CONTACT

If you have any questions, please feel free to contact us.

PRODUCTION & WHOLESALE

LEICKE GmbH

Stöhrerstr. 17

04347 Leipzig

Germany

Web: [www. leicke. com](http://www.leicke.com)

Mail: [info@ leicke. com](mailto:info@leicke.com)